

INFORMATION

Operation: May 1 - September 30, 9:00 am - 10:00 pm
 Information/Shelters: (208) 612-6000
 Booth: (208) 243-5911
 Parks & Rec. Manager: (208) 612-6000
 Web: www.co.jefferson.id.us
 Please clean up after your pet

ACTIVITIES

Boating (with restrictions)
 Camping
 Cycling
 Fishing
 Playground
 Tennis
 Volleyball
 Walking

LEGEND

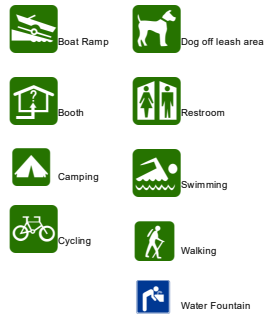

PARK REGULATIONS

1. Swim at your own risk.
2. No glass on beaches, boat dock, or playground.
3. No littering in any area.
4. No dogs allowed on grass/beach or water area from island path to campsite #1.
5. Dogs allowed loose in off leash area only. Leashes are required in all other areas.
6. Do not drive off of pavement.
7. No alcohol permitted in park.
8. No discharge of firearms.
9. Park closed after 10 p.m. except for camping.
10. Camping quiet hours are from 10 p.m. to 6 a.m.
11. Fires only in metal fire rings or grills.
12. Clean campsite prior to leaving.
13. Maximum stay of five (5) consecutive days.
14. An Idaho fishing license is required to fish except as allowed by State regulations.
15. No motorboats on the lake.

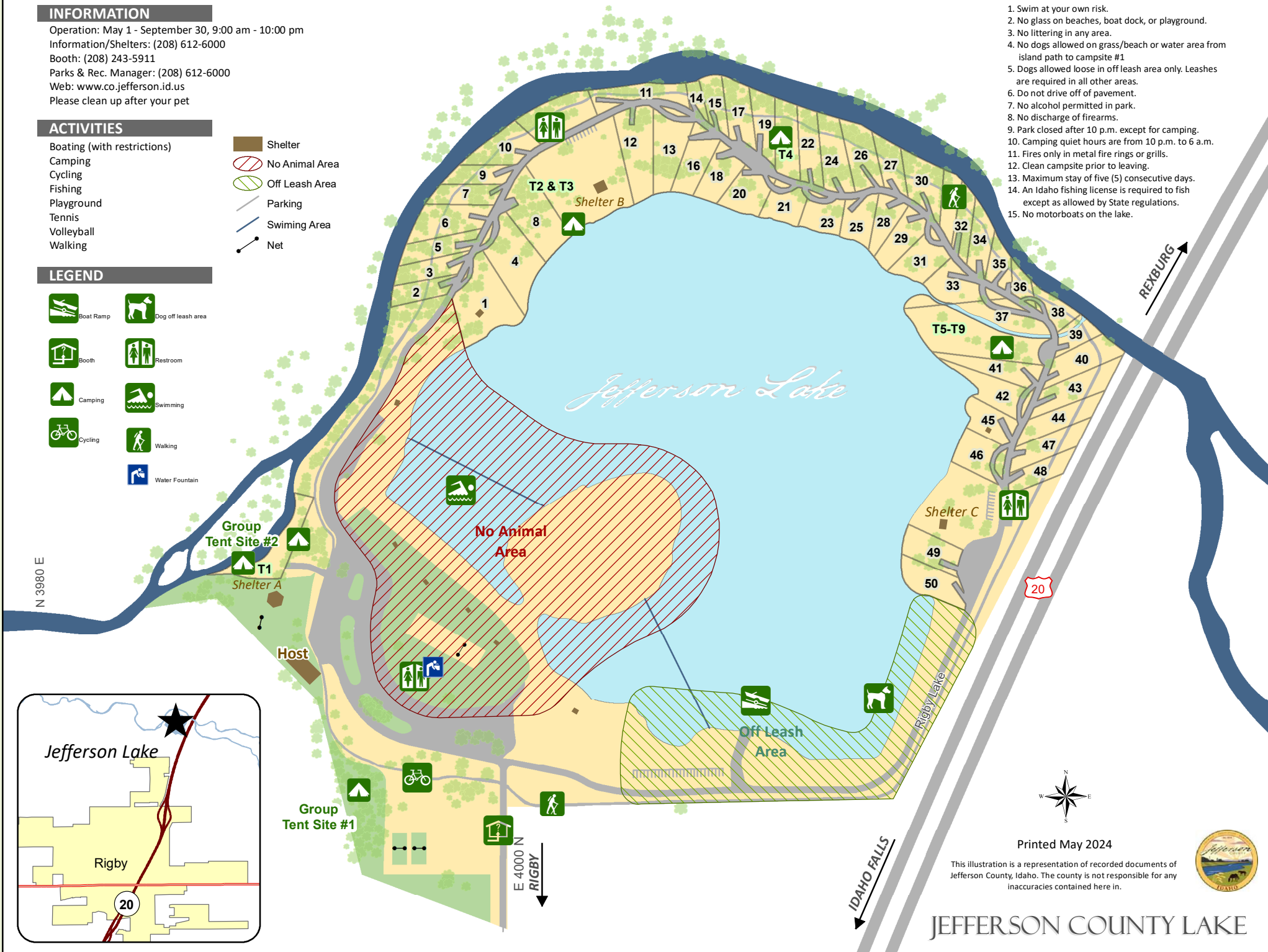

Printed May 2024

This illustration is a representation of recorded documents of Jefferson County, Idaho. The county is not responsible for any inaccuracies contained here in.



JEFFERSON COUNTY LAKE